



Bespoke Joinery Solutions
Dispensary Solutions V1.1

Product guide and technical information
sheet

Supplying the healthcare industry for over twenty years...

Plumline Bespoke Joinery have been producing Dispensary and Pharmacy solutions for over twenty years. Our expertise in this field has helped pioneer Pharmacy solutions for both major retailers and independent pharmacies up and down the country.

Using state of the art CNC machinery and Beam saw cutting technology in our 50,000 sq ft factory we are able to offer a single cabinet or a complete dispensary, delivered to your door in our own fleet of vehicles. Our factory facility based in Nottingham is centrally placed to service any part of the UK, our quick lead times and inhouse transportation gives the reassurance needed when the deadline is tight.

In these pages we have formulated an easy to use guide outlining the standard modules and specifications to help you plan your next job, to speed up the quotation times we have also formulated a retail pricing structure based on an industry standard specification although we can happily quote any size, material and specification that is required.

If you require and further information or prices please contact one of our expert sales team:

Craig Taylor - Sales Manager
Simon Johnson - Sales Executive
Matthew Buckley - Sales Executive
Rob Johnson - External Sales Executive



Plumline Bespoke Joinery Ltd
Hucknall Road
Sherwood
Nottingham
NG5 1FD

Phone: 0115 9629444
Fax: 0115 9691213
Email: info@plumline.co.uk
Web: www.plumline.co.uk

Part of the Langar Group of Companies www.langar.co.uk



Bespoke Joinery Solutions
Dispensary Solutions V1.1

Product guide and technical information
sheet

General specification...

40mm Axiom bullnosed laminated worktops, laminate edges.

18mm Egger white melamine faced MDF construction, screwed and fully assembled.

2mm ABS white Hi Impact edges

Metal recessed handles with black plastic insert.

150mm Black laminated MDF plinths edged in black laminate and balanced.

Metabox, metal sided drawer units complete with free-slide runners.

50mm Deep service void to rear or carcass for electrics
and pipework.

Blum external 90 degree door hinges.

150mm Adjustable black plastic barrel feet with clips for plinth.

Adjustable base unit shelves on book case strip & clips

Adjustable anti-tilt upper shelves on 5mm metal pegs

Standard size modules 600/1200 wide, 900 high.

Worktops 600 deep

Carcass 550 deep

Plinths 150 high

Other worktop, carcass and edging finishes available on request

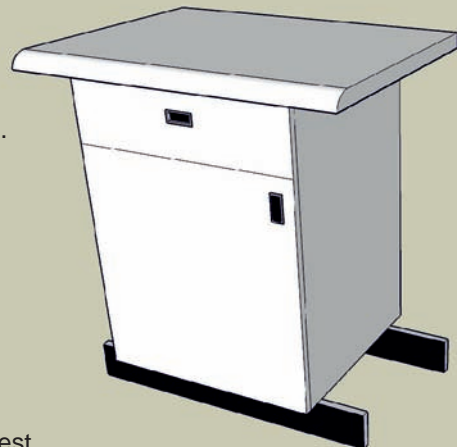

Plumline Bespoke Joinery Ltd
Hucknall Road
Sherwood
Nottingham
NG5 1FD

Phone: 0115 9629444
Fax: 0115 9691213
Email: info@plumline.co.uk
Web: www.plumline.co.uk

Part of the Langar Group of Companies www.langar.co.uk

Standard base units...

Dis001

Open unit complete with
1No Adjustable anti tilt shelf
500w & 600w

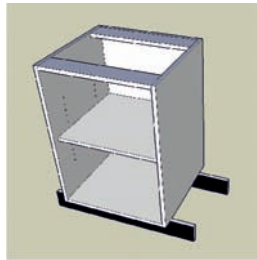

Dis004

Closed unit complete with
4No Pull out drawers
500w & 600w

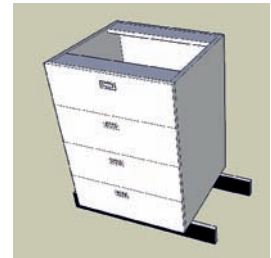

Dis002

Closed unit complete with
1No Adjustable anti tilt shelf
500w & 600w

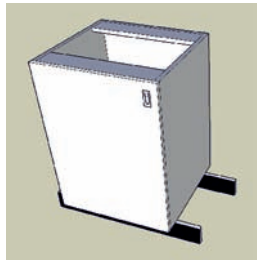

Dis005

Closed unit complete with
1No Bin + Bin door
500w & 600w

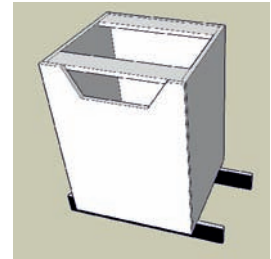

Dis003

Closed unit complete with
1No Adjustable anti tilt shelf
1No Pull out drawer
500w & 600w

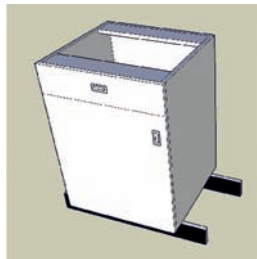

Dis006

Open unit complete with
2No Pull-out hopper drawers
500w & 600w

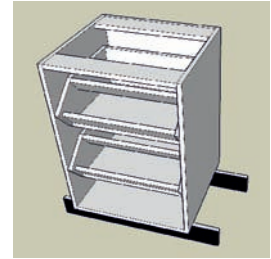

Additional options - Lockable doors + drawers

Standard shelving units...

Dis007

Open unit complete with

4No Adjustable
anti tilt shelves

500w & 600w



Dis010

Open low unit complete with

Open storage

1000w & 1200w

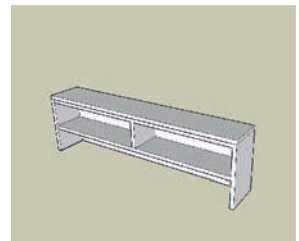

Dis008

Open unit complete with

8No Adjustable
anti tilt shelves

1000w & 1200w

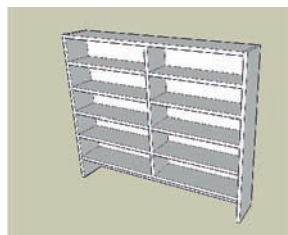

Dis011

Open unit complete with

7No Adjustable anti tilt shelves

500w & 600w

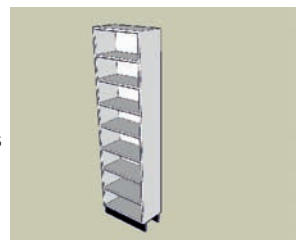

Dis009

Open sink unit
complete with

6No Adjustable
anti tilt shelves

1000w & 1200w

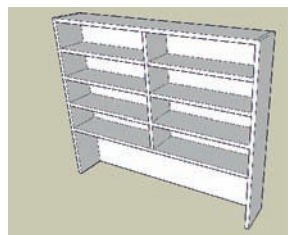

Dis012

Open unit complete with

14No Adjustable
anti tilt shelves

1000w & 1200w

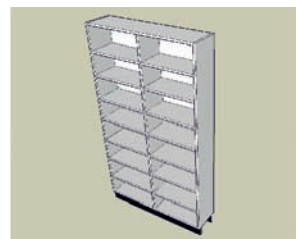

Additional options - Additional shelves